

LOVELY PLAY SPACES



Photo: Daniel Perales / Gathering Place of Tulsa, Oklahoma, USA

Richter Spielgeräte GmbH



POZUELO DE ALARCON, MADRID, SPAIN



The long-awaited Richter playground was ceremoniously opened in Pozuelo, an attractive suburb of Madrid, in February 2019.

The gigantic play pyramid and the two pyramid towers made of high-quality larch wood with striking stainless-steel wind chimes at the tips, which sparkle in the light, can be seen from afar and invite big and small to climb and explore them. Various combination elements, such as bridges, walkways and platforms invite you on an extensive tour of discovery.

There are not only numerous little niches to hide away in or use for role-playing games, there are also places with a view to sit, hangout and chat for older children and young people. The large tunnel slide and various firemen's poles also provide extra fun. And it's not only children that enjoy sliding from the pyramid's upper play level in a downwards rush.

The publically accessible playground is already fast on its way to becoming one of the main attractions in Pozuelos' parkland area.



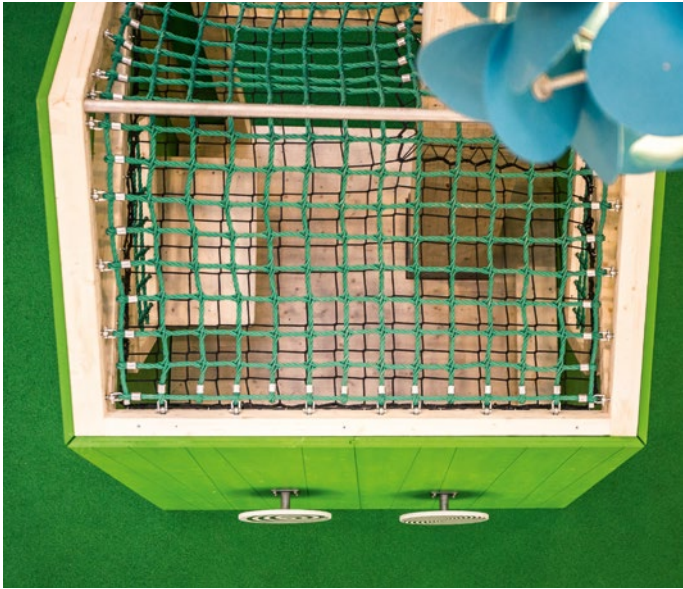

Idea: M. DE DREUZY / © CEN Photographie

The play structure, specially designed for the generous entrance area of the IKEA store in the French town of Bayonne, is a very special attraction.

The installation is based on the theme of "up in the trees" and composed of a total of eleven colourfully painted boxes, which are installed at different levels and fitted out with various window openings, net roofs and platform floors. The access points are connected to one another by climbing nets, tunnels and ladder elements. Notable highlights include the sky walk made up of a net tunnel and the 18-meter slide, which offers a fast getaway from the lofty heights to the ground.

These tree house modules offer opportunities to climb and play hide and seek as well as experience height in a secure environment behind the enclosed rope and net constructions. An important feature for parents, in the throng of people in this shopping centre, is that they can see their children through the climbing nets.

The rotating discs installed on the lower houses, are another special feature for stimulating the powers of sensory perception.

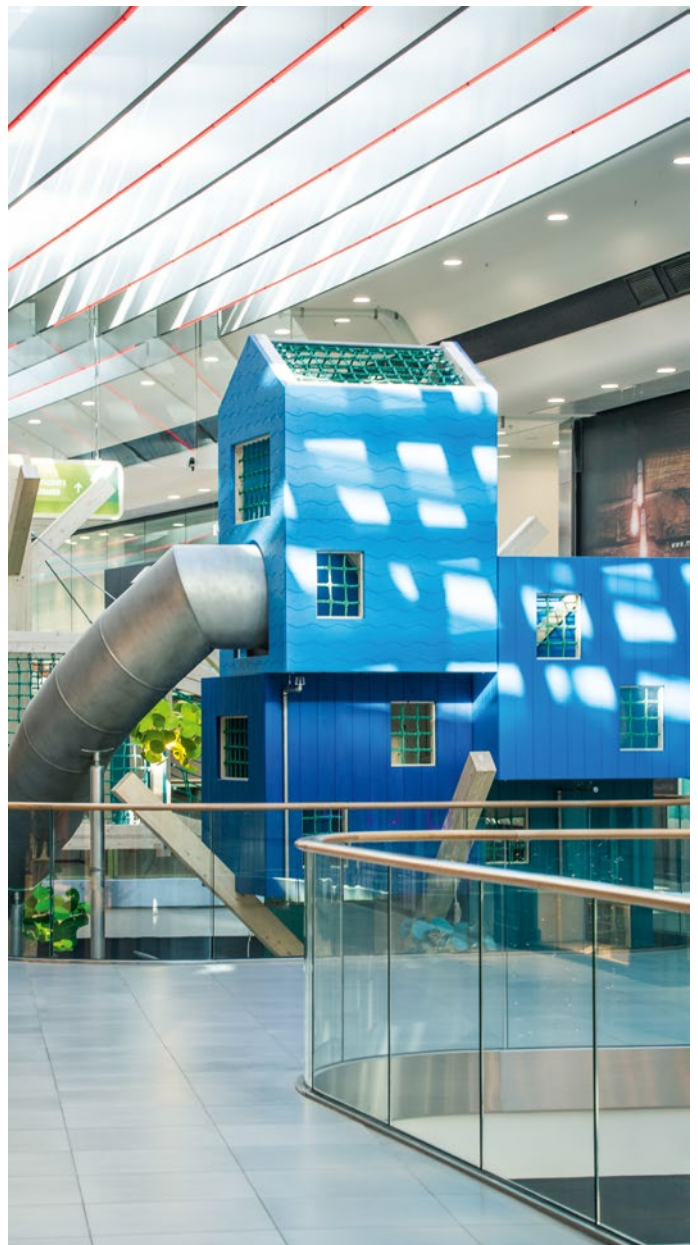



Photos: Anton Donikov / © Garage Museum of Contemporary Art

Russia's largest and most modern children's playground was opened in Gorky Park in Moscow in August 2018. Various play areas are situated here between the existing tree population. Arranged according to theme, they include, water, swings, sand and action, for example. The undisputed main attractions of this ambitious urban project are the high climbing towers, connected by a skywalk,

which can be seen from afar, and the so-called stainless-steel "Mega-Swing", which was designed especially for this playground. It also boasts various swings, hung at different heights on an expansive curved steel construction that rises at one side. The ellipse is fitted with interactive movement sensors that light up the swings with an aesthetic play of colours in the twilight and after dark.



BØRNElund PLAYVILLE, OSAKA/JAPAN



A very special playground was opened in Osaka, Japan, in 2019.

BørneLund operates 90 toy stores and over 20 indoor playground centres in Japan. Up to now, there have been very few creative playgrounds made of wood in Japan. Richter and BørneLund are therefore setting a new trend for Japan with this project.

In the sand and water area, younger children in particular enjoy playing with the elements at the Water Channels, Pumps and Mud Tables. The Cradle Nest invites children to take a little



Photos: Ayumi Nakanishi

time out and there's space to hide away and for role-playing games in the Small Play Houses. The "active play" area, with its challenging Towers, Bridges, Climbing Nets and Slides, particularly appeals to older children. With the addition of Dance Chimes, a Whirlpool Column and a Small Singing Stone, there are also exciting experience fields for the senses, which even adults can't resist trying out. With their cheery sounds, the square Sound Cushions provide additional enjoyment for big and small.



PLAYMOBIL TREEHOUSE, DIESPECK/GERMANY



The PLAYMOBIL discovery tree house was opened at the Diespeck primary and intermediate school in early July 2018 – a generous gift from the German charitable foundation called “Stiftung Kinderförderung von PLAYMOBIL”. The tree house, which is approximately eleven metres long, fifteen meters wide and six metres high, gives children and young people the opportunity to explore, play hide and seek and challenge themselves to conquer the different accesses. The solid wooden structure provides both a special place to learn right in the middle of nature and a cosy space to hang out and play in.

